

OPERATOR'S MANUAL

CM0645G1XXXXXXX

INCLUDING: OPERATION, INSTALLATION AND MAINTENANCE.

RELEASED: 3-24-10

INCLUDE MANUALS: AF0645GXXXXXX-XX-X PUMP (pn 97999-1507) 66301-X LOWER PUMP END (pn 97999-647), & (REV. 01)
GENERAL INFORMATION S-636 (pn 97999-636)

6" AIR MOTOR
45:1 RATIO
6" STROKE

CM0645G1XXXXXXX PUMP AND CART PACKAGE



**READ THIS MANUAL CAREFULLY BEFORE INSTALLING,
OPERATING OR SERVICING THIS EQUIPMENT.**

It is the responsibility of the employer to place this information in the hands of the operator. Keep for future reference.

SERVICE KITS

- Use only genuine ARO replacement parts to assure compatible pressure rating and longest service life.
- **637489** for repair of Air Motor section.
- **637306-X43** for repair of Lower Pump section.

MODEL DESCRIPTION

CM 06 45 G 1 XXXXX XX X

Package Type

CM - Cart Mounted

Air Motor Size

06 - 6"

Pump Ratio

45 - 45:1

Check Type / Wetted Materials

G - 2 Ball / Hard SS with Big Inlet

Container Suitability

1 - Stub

Lower Pump End Options

Refer to pump model operator's manual

Follower Assembly

00 - None

Package Option

0 - None

1 - Integrated ball valve regulator on pump

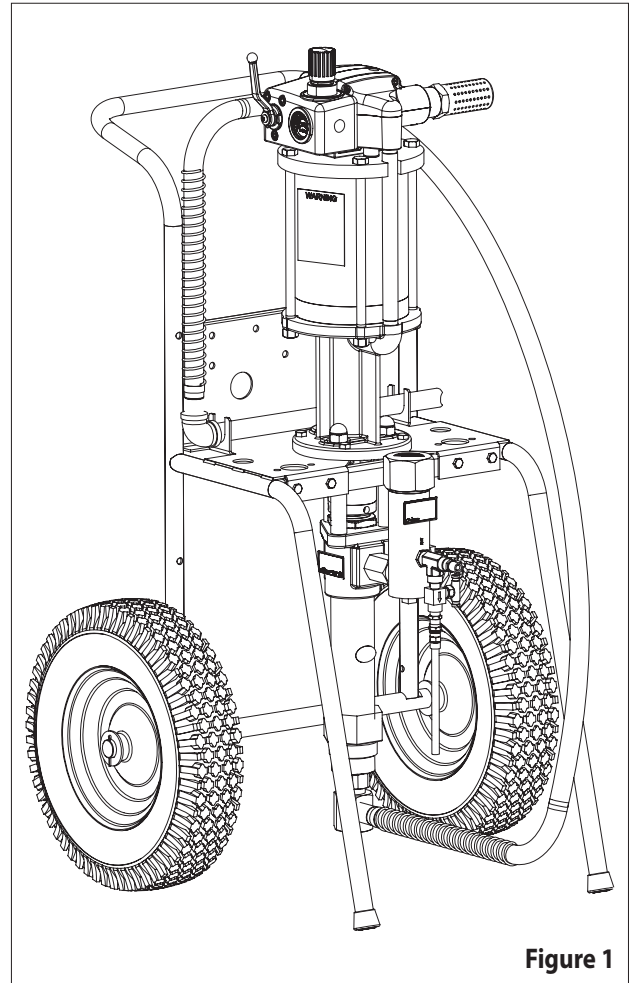

Figure 1

GENERAL DESCRIPTION

By delivering a smooth, continuous bead of the proper size, an ARO system helps the operator maintain both production rate and produce high quality standards. Maintained quality standards assures that the material benefits are realized. To further maximize operator production time, the ARO system has a built-in lift / ram feature for quick and easy drum changeover and easy lifting of the pump assembly from the container.

ARO systems are totally enclosed, sealing the material in the system from air and moisture, preventing premature cure-out of the material. This allows for either continuous or intermittent use of the system and allows the need for daily system clean-up.

INGERSOLL RAND COMPANY LTD

209 NORTH MAIN STREET -BRYAN, OHIO 43506

☎ (800) 495-0276 • FAX (800) 892-6276

© 2010

CCN 15337496

www.ingersollrandproducts.com

ARO

IR Ingersoll Rand
Industrial Technologies

PARTS LIST / CM0645GXXXXXXX

Item	Description (size)	Qty	Part No.
1	Pump Assembly	(1)	AF0645G1XXXXX
2	Cart Assembly	(1)	67139
3	Plug (3/8")	(2)	Y17-13-S
4	Suction Tube	(1)	94263-1
5	3/4" Suction Hose Assembly	(1)	622606-5
6	90° Elbow (3/4")	(1)	Y43-15-S
7	Plug	(1)	Y17-11-S
8	90° Adapter (1" (m) x 1/4" (f) x 3/4" (f))	(1)	95254
9	Nut (3/8" - 16)	(4)	Y12-6-C
10	Screw (3/8" - 16 x 1-1/4")	(4)	Y6-66-C
11	Washer (3/8")	(4)	Y13-6-C

Item	Description (size)	Qty	Part No.
12	Material Filter (includes item 3)	(1)	651422-50
13	Bushing (1/2" - 14 (m) x 1/4" - 18 (f))	(1)	94271
14	Street Tee (1/4" - 18)	(1)	94270
15	Nipple (1/4" - 18 (m))	(1)	1950
16	Needle Valve	(1)	94269
17	Hose Assembly	(1)	628092-F
18	Adapter (1" (m" x 1/4" (f) x 3/4" (f))	(1)	94256

OPERATING INSTRUCTIONS

⚠ WARNING Do not exceed maximum operating pressure of 5400 p.s.i. (372 Bar) at 120 p.s.i. (8.3 Bar) air inlet pressure.

⚠ WARNING Refer the pump manual (pn 97999-1507) for additional operating and safety precautions and other important information.

INSTALLATION

OPERATING INSTRUCTIONS / INITIAL SETUP PROCEDURE

This unit comes assembled except for the air supply hose, gun and material hose which must be attached.

- A connector, coupler and air supply hose and must be supplied to the air regulator.
 - Attach a Ground wire to a suitable ground and the Ground Lug provided on the pump Air Motor.
 - Keep containers covered to prevent contamination.
1. Turn the knob on the air regulator counter-clockwise to zero p.s.i.
 2. Attach hose and gun. Place pump inlet tube into a full container of material.
 3. Start the pump to cycle by turning the air regulator knob clockwise. The pump will cycle several strokes until pressure is built up in the system, at which time it will stall, check for any loose fittings or leakage. Check all connections and re-tighten as necessary.
 4. Needle Valve (18) is used to relieve pressure in the hose in order to change spray tips. Open the relief valve to relieve pressure. Close the relief valve to continue spray operation.

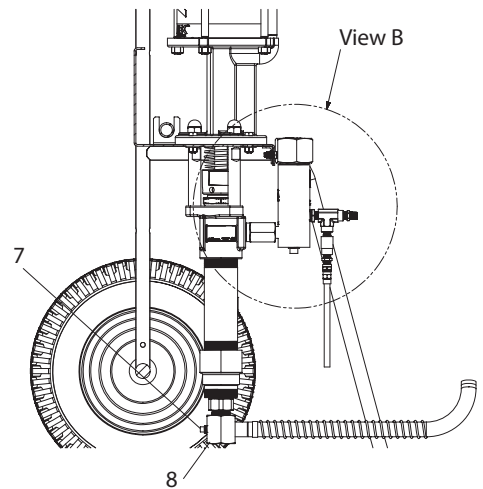
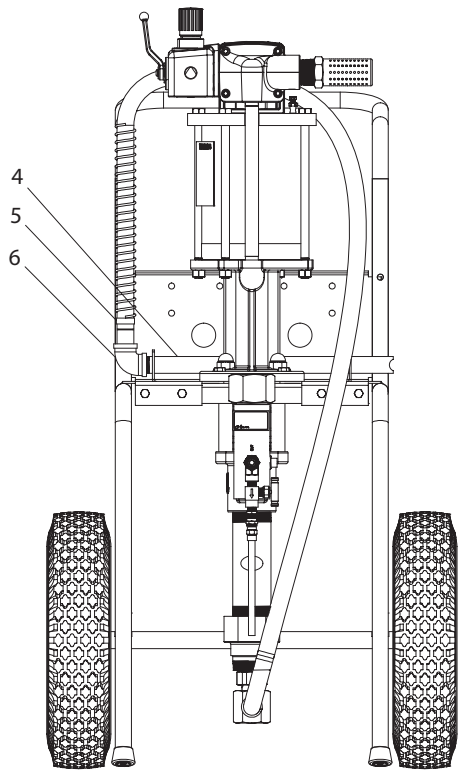
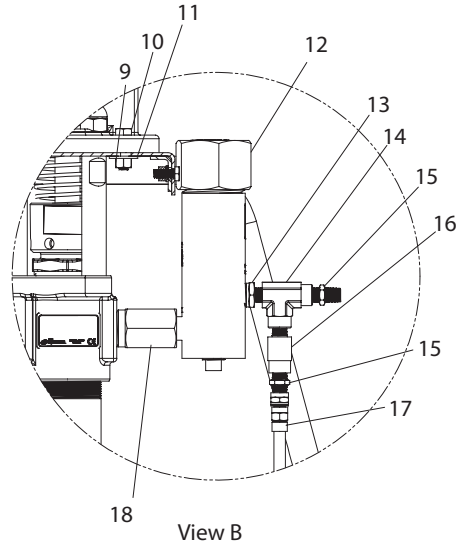
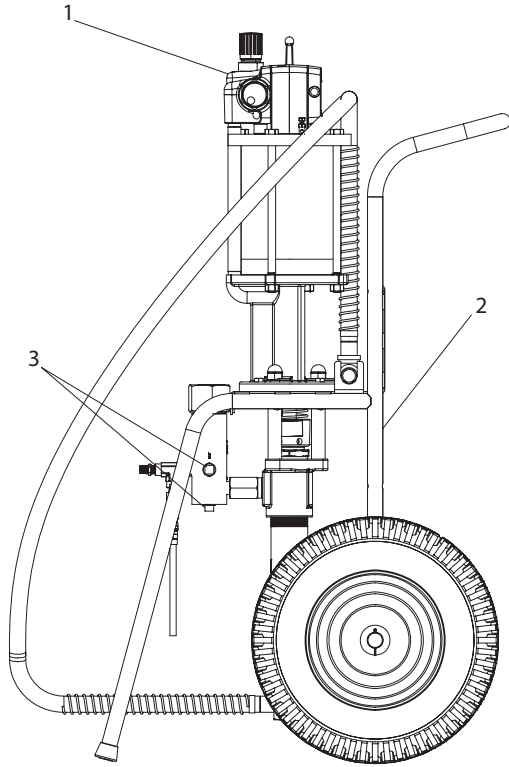

Figure 2

DIMENSIONS

